

View shown without plastic pin and grounding

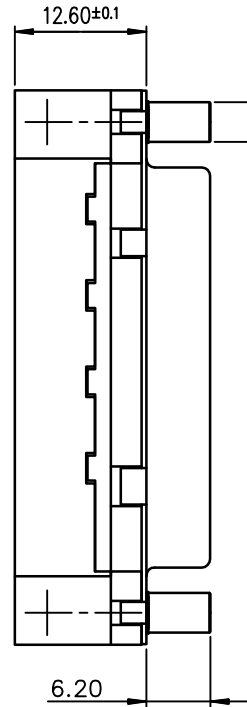

Detail of grounding strip

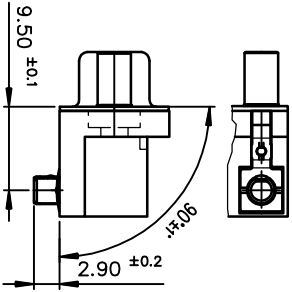

PC card drilling dimensions(after plating)
(thickness 1.60 ±0.25 mm)

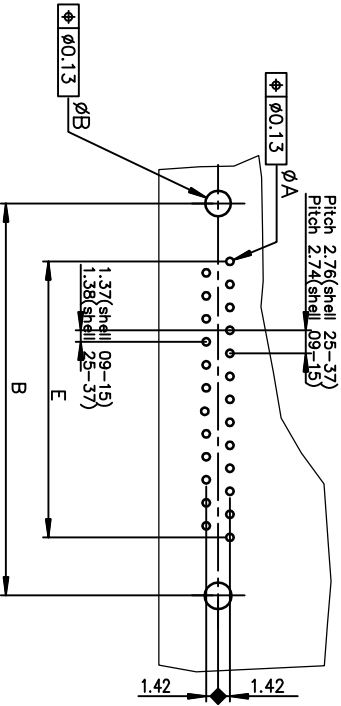

SHELL	A±0.38	B±0.12	C±0.10	D±0.25	E±0.07	TIN LEAD PART NUMBER
09	30.81	24.99	18.00	16.21	10.96	D09S80C4GV00 D09S80C6GV00 D09S80C8GV00
15	39.14	33.32	26.32	24.54	19.18	D15S80C4GV00 D15S80C6GV00 D15S80C8GV00
25	53.03	47.04	40.04	38.25	33.12	D25S80C4GV00 D25S80C6GV00 D25S80C8GV00
37	69.32	63.50	56.50	54.71	49.68	D37S80C4GV00 D37S80C6GV00 D37S80C8GV00

SHELL	A±0.38	B±0.12	C±0.10	D±0.25	E±0.07	LEAD FREE PART NUMBER
09	30.81	24.99	18.00	16.21	10.96	D09S80C4GV00LF D09S80C6GV00LF D09S80C8GV00LF
15	39.14	33.32	26.32	24.54	19.18	D15S80C4GV00LF D15S80C6GV00LF D15S80C8GV00LF
25	53.03	47.04	40.04	38.25	33.12	D25S80C4GV00LF D25S80C6GV00LF D25S80C8GV00LF
37	69.32	63.50	56.50	54.71	49.68	D37S80C4GV00LF D37S80C6GV00LF D37S80C8GV00LF

GENERAL CHARACTERISTICS AND ROHS INFORMATIONS:
SEE DRAWING C01-8646-0001

mat'l. code		ISO 1302	tolerance	projection	product family
J	EX-17889 MP	2014/06/08	ISO 406 ISO 1001	MM	D-SUB
dr	PESSON	1995/10/31	ISO 406 ISO 1001	MM	FEMALE CONNECTOR DELTA-D
engr	WITHUN PAUL	2014/06/06	ISO 406 ISO 1001	MM	US RA PF
chr	ALAS BABU	2014/06/06	ISO 406 ISO 1001	MM	
appr	BLIU K PAUL	2014/06/06	ISO 406 ISO 1001	MM	
sheet index	revision	J	1		

dwg no C01-8646-0412
sheet 1 of 1
size A3



Product Customer Drawing