

3M™ Pak 50 Socket

.050" Straight and Right Angle Socket, with Ret. Clips, Flng. Option

P50 Series

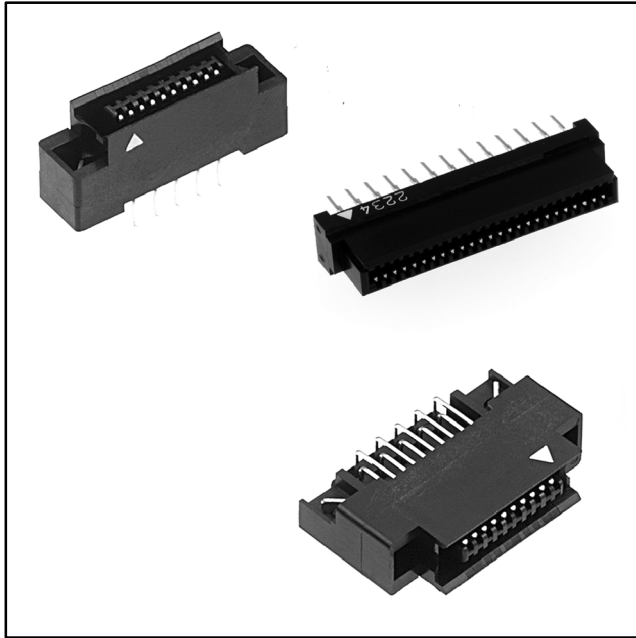

- Contact design features two contact points and straight beam construction for connector reliability and low insertion force
- Available retention clip secures connector for wave soldering eliminating additional hardware expenses
- Horizontal, parallel or vertical mating available
- Insulator design prevents mis-insertion errors and contact damage
- Available with and without flanges

Date Modified: May 15, 2003

TS-2047-01
Sheet 1 of 5

Physical

Insulation
Material: Glass Filled Nylon
Flammability: UL 94V-0
Color: Black

Contact
Material: Phosphor Bronze

Plating
Underplating: Nickel
Wiping Area: See Ordering Information
Solder Tails: Tin Alloy over Nickel

Electrical

Current Rating: 0.5 A
Insulation Resistance: 10^3 M Ω min. at 500V DC
Withstanding Voltage: 650V AC for 1 minute

Environmental

Temperature Rating: -55°C to +85°C

UL File No.: E68080

3M
Interconnect Solutions
<http://www.3M.com/interconnects/>

3M is a trademark of 3M Company.
For technical, sales or ordering information call
800-225-5373

3M™ Pak 50 Socket

.050" Straight and Right Angle Socket, with Ret. Clips, Flng. Option

P50 Series

Straight with Flanges, with and without Retention Clips

Product Table / Dimensions for Straight Plug with and without Retention Clips

Contact Quantity	A	B	C	D
20	25.43 [1.001]	20.32 [0.800]	15.43 [0.608]	11.43 [0.450]
26	29.24 [1.151]	24.13 [0.950]	19.24 [0.758]	15.24 [0.600]
30	31.78 [1.251]	26.67 [1.050]	21.78 [0.858]	17.78 [0.700]
32	33.05 [1.301]	27.94 [1.100]	23.05 [0.908]	19.05 [0.750]
34	34.32 [1.351]	29.21 [1.150]	24.32 [0.958]	20.32 [0.800]
40	38.13 [1.501]	33.02 [1.300]	28.13 [1.108]	24.13 [0.950]

Contact Quantity	A	B	C	D
50	44.48 [1.751]	39.37 [1.550]	34.48 [1.358]	30.48 [1.200]
52	45.75 [1.801]	40.64 [1.600]	35.75 [1.408]	31.75 [1.250]
60	50.83 [2.001]	45.72 [1.800]	40.83 [1.608]	36.83 [1.450]
68	55.91 [2.201]	50.80 [2.000]	45.91 [1.808]	41.91 [1.650]
80	63.53 [2.501]	58.42 [2.300]	53.53 [2.108]	49.53 [1.950]
100	76.23 [3.001]	71.12 [2.800]	66.23 [2.608]	62.23 [2.450]



With Retention Clips

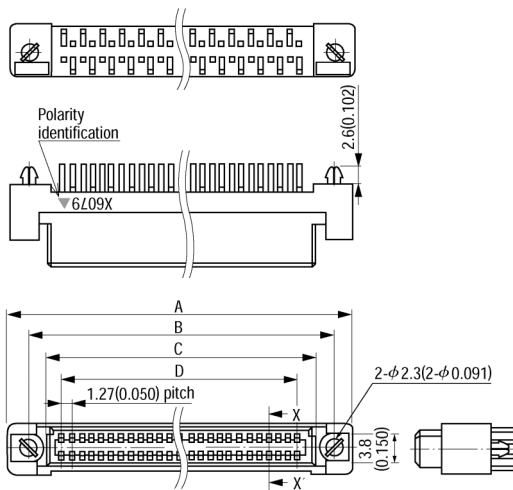

Without Retention Clips

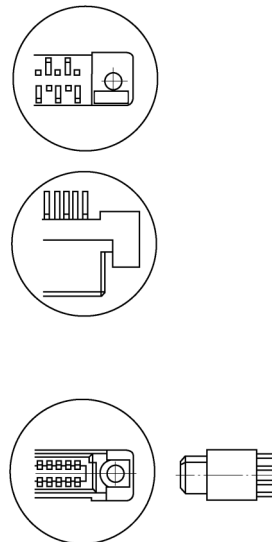

X-X' Cross Section

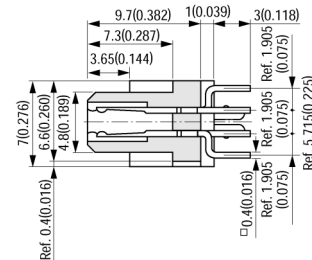

Printed Circuit Board Layout (Component Side View)

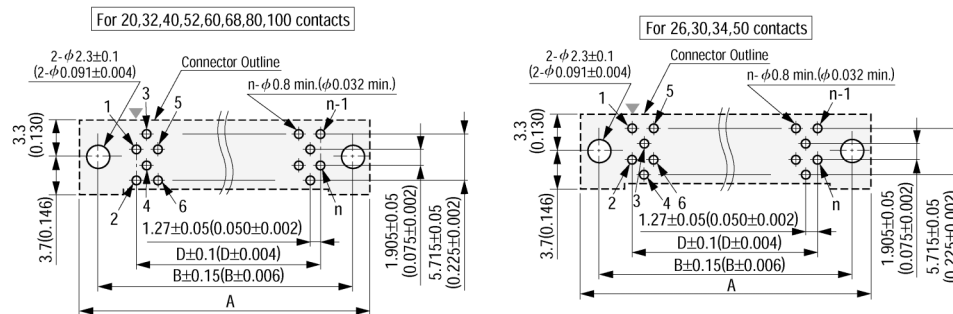

▽ = Polarity identification
 Recommended PCB Thickness $t = 1.6 \pm 0.19(0.063 \pm 0.007)$
 "n" is number of contacts.

TS-2047-01
 Sheet 2 of 5

3M™ Pak 50 Socket

.050" Straight and Right Angle Socket, with Ret. Clips, Flng. Option

P50 Series

Without Flanges

Product Table / Dimensions for Straight Plug without Flanges

Contact Quantity	A	B	C
20	17.83	15.43	11.43
	[0.702]	[0.608]	[0.450]
26	21.64	19.24	15.24
	[0.852]	[0.758]	[0.600]
30	24.18	21.78	17.78
	[0.952]	[0.858]	[0.700]
32	25.45	23.05	19.05
	[1.002]	[0.908]	[0.750]
34	26.72	24.32	20.32
	[1.052]	[0.958]	[0.800]
40	30.53	28.13	24.13
	[1.202]	[1.108]	[0.950]

Contact Quantity	A	B	C
50	36.88	34.48	30.48
	[1.452]	[1.358]	[1.200]
52	38.15	35.75	31.75
	[1.502]	[1.408]	[1.250]
60	43.23	40.83	36.83
	[1.702]	[1.608]	[1.450]
68	48.31	45.91	41.91
	[1.902]	[1.808]	[1.650]
80	55.93	53.53	49.53
	[2.202]	[2.108]	[1.950]
100	68.63	66.23	62.23
	[2.702]	[2.608]	[2.450]

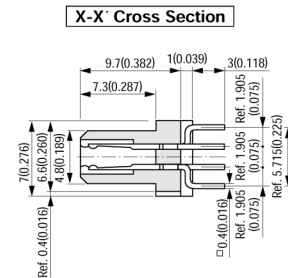

Printed Circuit Board Layout (Component Side View)

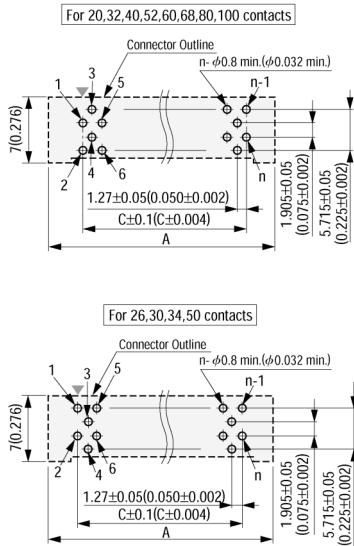

▼ = Polarity identification
 Recommended PCB Thickness $t = 1.6 \pm 0.19 (0.063 \pm 0.007)$
 n is number of contacts.

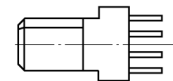
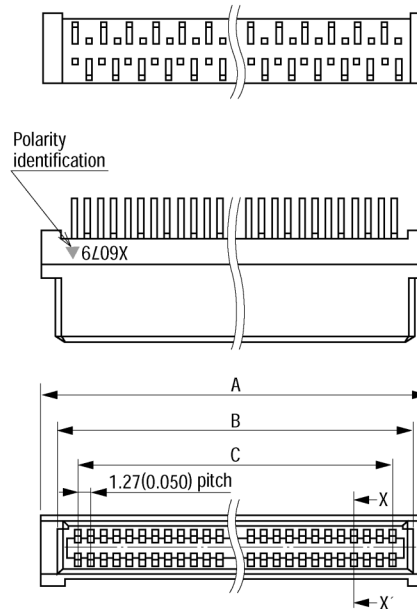

Ordering Information

P5X - XXXS - XXX - XXXX

Mounting Options:
 0 = With Flanges
 1 = Without Flanges, offered without retention clips only

Contact Quantity
 See Table

Solder Tail and Clip Options:
 S1 = Straight without retention clips
 SR1 = Right Angle without retention clips
 *R1 = Straight with retention clips
 *RR1 = Right Angle with retention clips

Plating Options:
 TGF = 2μ [0.05μ] min. Gold
 TG = 10μ [0.25μ] min. Gold
 TG30 = 30μ [0.75μ] min. Gold

*Note: R1 and RR1 do not apply to P51

TS-2047-01
 Sheet 3 of 5

3M™ Pak 50 Socket

.050" Straight and Right Angle Socket, with Ret. Clips, Flng. Option

P50 Series

Right Angle with Flanges

Product Table / Dimensions for Right Angle Plug with and without Retention

Contact Quantity	A	B	C	D
20	25.43 [1.001]	20.32 [0.800]	15.43 [0.608]	11.43 [0.450]
26	29.24 [1.151]	24.13 [0.950]	19.24 [0.758]	15.24 [0.600]
30	31.78 [1.251]	26.67 [1.050]	21.78 [0.858]	17.78 [0.700]
32	33.05 [1.301]	27.94 [1.100]	23.05 [0.908]	19.05 [0.750]
34	34.32 [1.351]	29.21 [1.150]	24.32 [0.958]	20.32 [0.800]
40	38.13 [1.501]	33.02 [1.300]	28.13 [1.108]	24.13 [0.950]

Contact Quantity	A	B	C	D
50	44.48 [1.751]	39.37 [1.550]	34.48 [1.358]	30.48 [1.200]
52	45.75 [1.801]	40.64 [1.600]	35.75 [1.408]	31.75 [1.250]
60	50.83 [2.001]	45.72 [1.800]	40.83 [1.608]	36.83 [1.450]
68	55.91 [2.201]	50.80 [2.000]	45.91 [1.808]	41.91 [1.650]
80	63.53 [2.501]	58.42 [2.300]	53.53 [2.108]	49.53 [1.950]
100	76.23 [3.001]	71.12 [2.800]	66.23 [2.608]	62.23 [2.450]

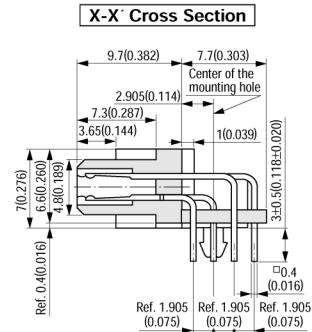
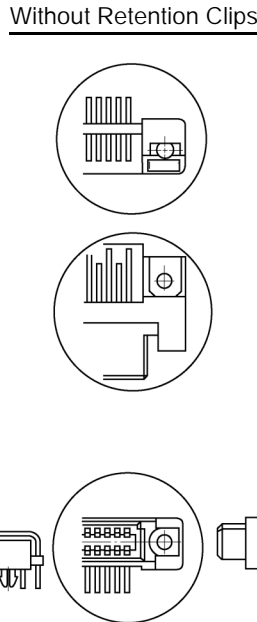
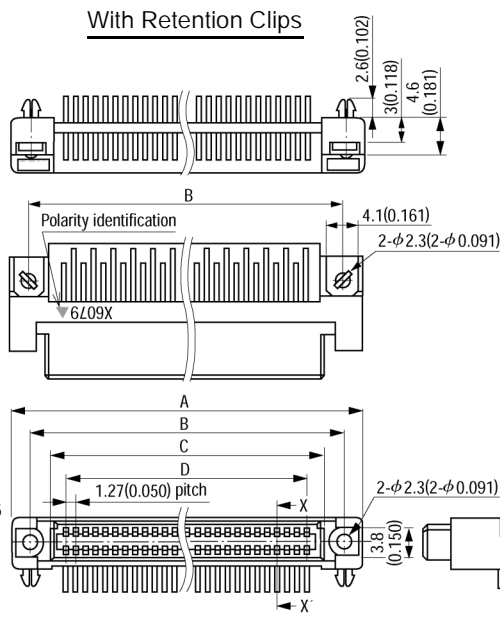

Printed Circuit Board Layout (Component Side View)

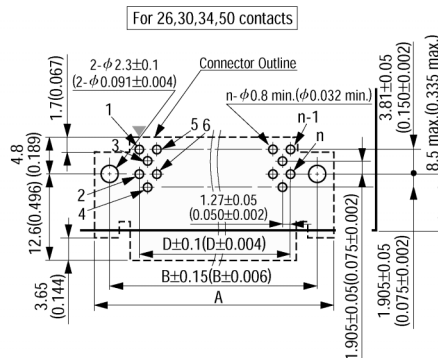
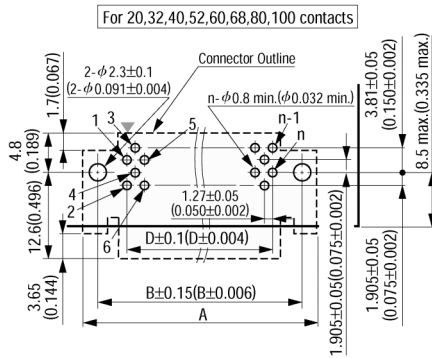

▼ = Polarity identification
 Recommended PCB Thickness $t = 1.6 \pm 0.19 (0.063 \pm 0.007)$
 "n" is number of contacts.

3M™ Pak 50 Socket

.050" Straight and Right Angle Socket, with Ret. Clips, Flng. Option

P50 Series

Right Angle without Flanges

Product Table / Dimensions for Right Angle Plug without Flanges

Contact Quantity	A	B	C
20	17.83	15.43	11.43
	[0.702]	[0.608]	[0.450]
26	21.64	19.24	15.24
	[0.852]	[0.758]	[0.600]
30	24.18	21.78	17.78
	[0.952]	[0.858]	[0.700]
32	25.45	23.05	19.05
	[1.002]	[0.908]	[0.750]
34	26.72	24.32	20.32
	[1.052]	[0.958]	[0.800]
40	30.53	28.13	24.13
	[1.202]	[1.108]	[0.950]

Contact Quantity	A	B	C
50	36.88	34.48	30.48
	[1.452]	[1.358]	[1.200]
52	38.15	35.75	31.75
	[1.502]	[1.408]	[1.250]
60	43.23	40.83	36.83
	[1.702]	[1.608]	[1.450]
68	48.31	45.91	41.91
	[1.902]	[1.808]	[1.650]
80	55.93	53.53	49.53
	[2.202]	[2.108]	[1.950]
100	68.63	66.23	62.23
	[2.702]	[2.608]	[2.450]

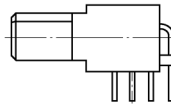
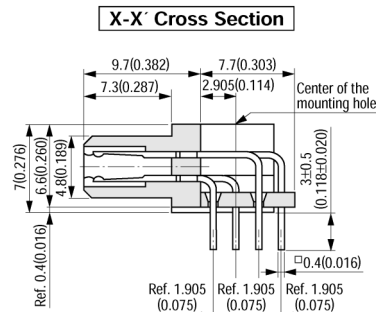
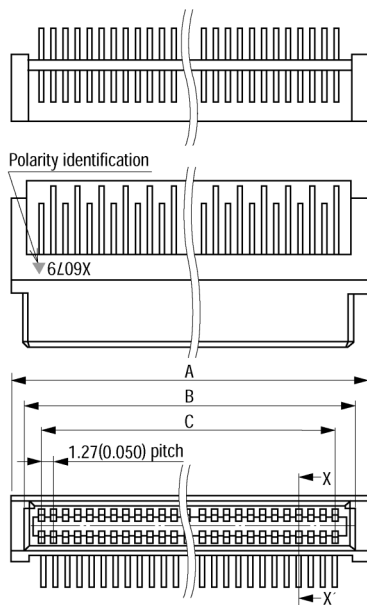

Printed Circuit Board Layout (Component Side View)

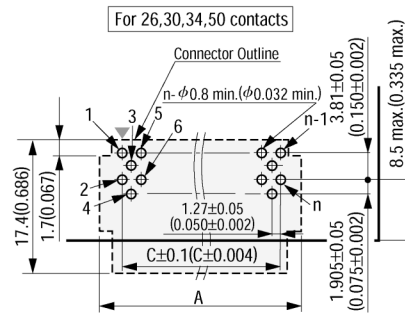
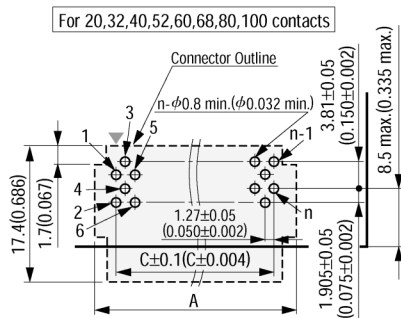

▼ = Polarity identification
 Recommended PCB Thickness $t = 1.6 \pm 0.19 (0.063 \pm 0.007)$
 "n" is number of contacts.

TS-2047-01
 Sheet 5 of 5

Important Notice

All statements, technical information, and recommendations related to 3M's products are based on information believed to be reliable, but the accuracy or completeness is not guaranteed. Before using this product, you must evaluate it and determine if it is suitable for your intended application. You assume all risks and liability associated with such use. Any statements related to the product which are not contained in 3M's current publications, or any contrary statements contained on your purchase order shall have no force or effect unless expressly agreed upon, in writing, by an authorized officer of 3M.



Electronic and Interconnect Solutions Division

6801 River Place Blvd.
Austin, TX 78726-9000
www.3M.com/eisd

Warranty; Limited Remedy; Limited Liability.

This product will be free from defects in material and manufacture for a period of 1 year from the date of purchase. **3M MAKES NO OTHER WARRANTIES INCLUDING, BUT NOT LIMITED TO, ANY IMPLIED WARRANTY OF MERCHANTABILITY OR FITNESS FOR A PARTICULAR PURPOSE.** If this product is defective within the warranty period stated above, your exclusive remedy shall be, at 3M's option, to replace or repair the 3M product or refund the purchase price of the 3M product. **Except where prohibited by law, 3M will not be liable for any loss or damage arising from this 3M product, whether direct, indirect, special, incidental or consequential regardless of the legal theory asserted.**