

1 0 1 0 2  
3 0 0 4  
a-L-b (+)

SPST  
CONTACT CONFIGURATION

PARTS LIST			
ITEM	QTY.	PART NO.	PART DESCRIPTION
1	1	F040024	D16 EE T1 3
2	1	F050412	50-004-12 (RED NEON BULB.)
3	1	F050204	50-002-04 (TRANSPARENT RED lens)

NOTES:

1. ALL DIMENSIONS IN MM
2. GENERAL TOLERANCE: X.X=±0.4  
X.XX=±0.25
3. RATINGS: 5A@250V AC,  
8A@125V AC
4. LAMP VOLTAGE: 110VAC (NEON BULB)
5. CONTACT MATERIAL: COPPER ALLOY W/Gold Plating
6. TRAVEL: 3.0mm (Total)
7. MECHANICAL LIFE: >100,000 Cycles
8. ELECTRICAL LIFE: >50,000 Cycles
9. INSULATION RESISTANCE: >1000 MILLI-OHMS
10. OPERATING TEMP: -20°C to 55°C

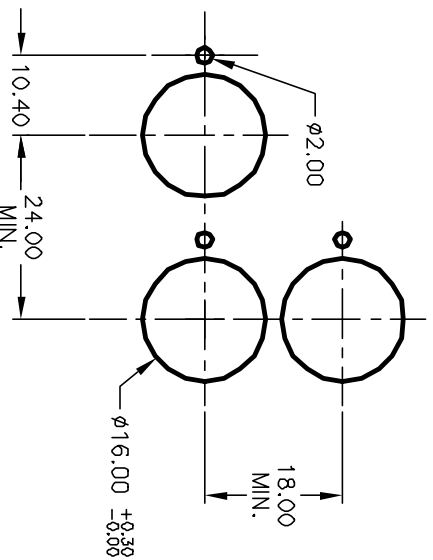

RECOMMENDED PANEL MOUNTING  
SCALE 1:1

**E-SWITCH®**

REV.	ECN No.	RELEASE FOR PRODUCTION	DESCRIPTION	DATE	CHKD
A	12387	8/27/02	D16 EE T13 K RED RED TRANSPARENT/CONCAVE LENS	CJB	

TITLE	SCALE	DATE	DR	DWG	REV
D16 EE T13 K RED RED TRANSPARENT/CONCAVE LENS	1.5:1	8/27/02	CB	XF0501P	A

THE INFORMATION CONTAINED IN THIS DOCUMENT IS PROPRIETARY TO E-SWITCH AND IS NOT TO BE COPIED OR TRANSFERRED