

RECOMMENDED P.C.B. LAYOUT

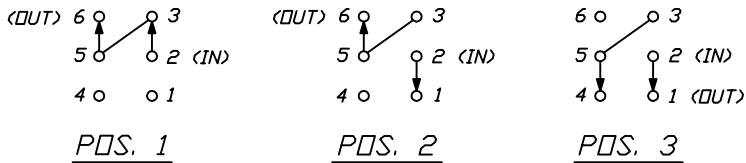

CIRCUIT: DPDT 3-WAY

NOTE: JUMPER PIN 3 TO PIN 5

SWITCH FUNCTION		
POS. 1	POS. 2	POS. 3
ON	ON	ON
2-3,5-6	2-1,5-6	2-1,5-4

NOTES:

- ALL DIMENSIONS IN MM [INCH]
- GENERAL TOLERANCE: X.X=±0.4
X.XX=±0.25
- TERMINAL NUMBERS FOR REF ONLY
- RATING: 5A @120VAC OR 28VDC;
2A @250VAC
- FIXED TERM. & MOVING CONTACT:
COPPER ALLOY w/Silver plate.
- ELECTRIC LIFE: 50,000 make-and-break cycles
at full load.
- INSULATION RESISTANCE: 1,000 Mega-ohm min.
- DIELECTRIC STRENGTH: 1,000 V RMS @sea level.
- OPERATING TEMP.: -30°C to +85°C

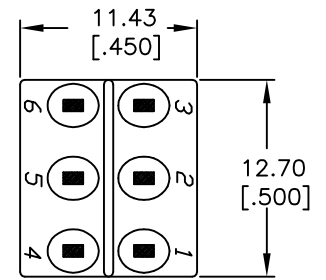
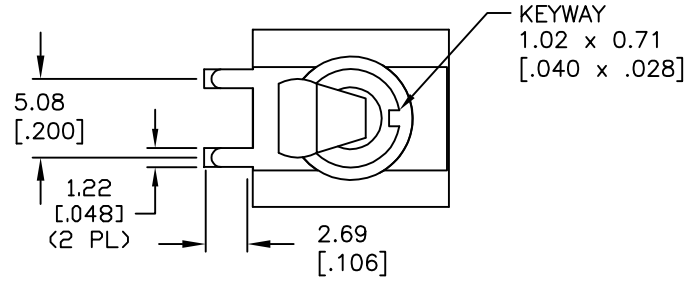

SECTION A-A
CROPPED FOR CLARITY

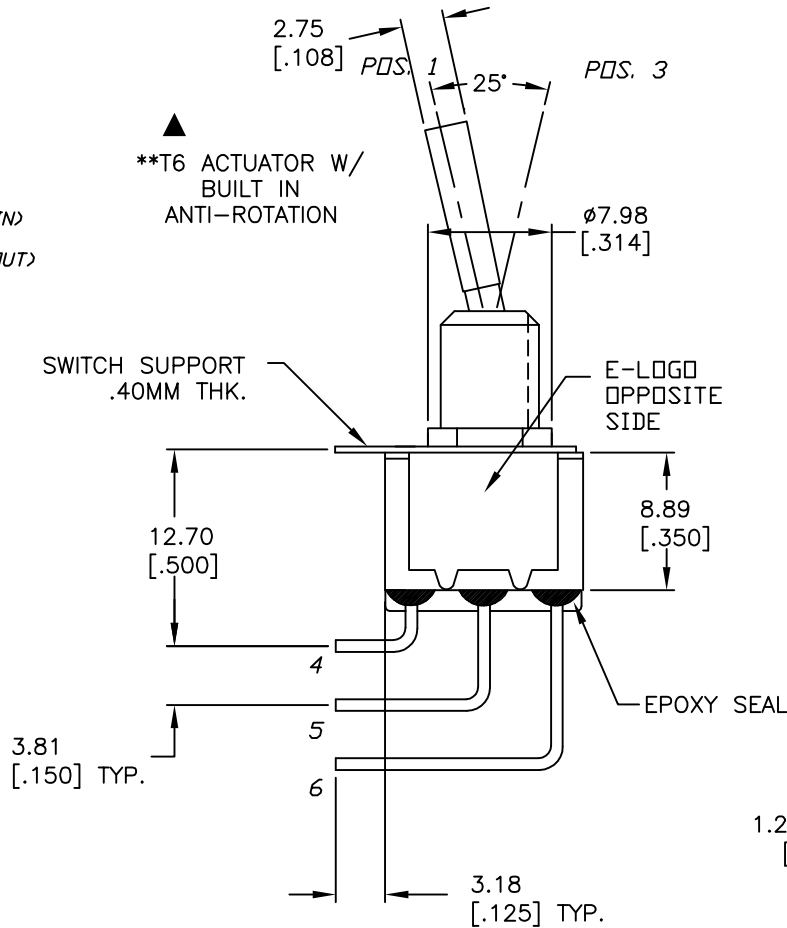
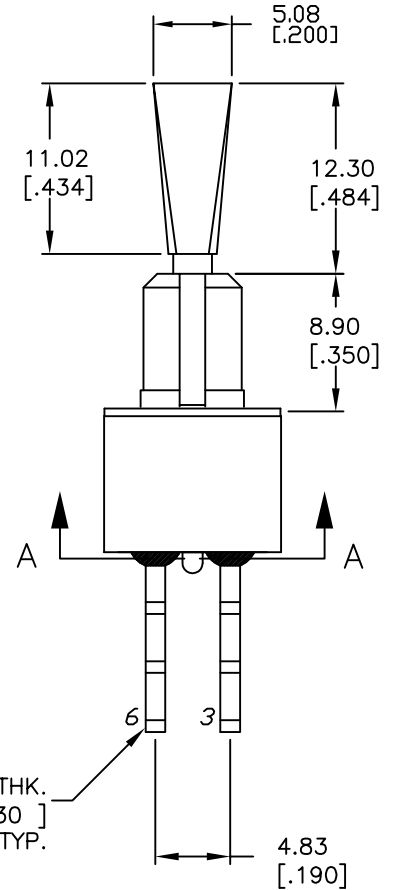

1.27 X 0.76 THK.
[.050 X .030]
TYP.

E-SWITCH®

B	22594	UPDATED PIN NUMBERING	11/17/16	MJR	TITLE	100 DP-6 T6 B12 M7 Q E								
A	12088	RELEASED FOR PRODUCTION	4/25/02	CB	SCALE	2:1	DATE	4/25/02	DR	CB	DWG	T126021	REV	B
REV.	ECN No.	DESCRIPTION	DATE	CHKD										

THE INFORMATION CONTAINED IN THIS DOCUMENT IS PROPRIETARY TO E-SWITCH AND IS NOT TO BE COPIED OR TRANSFERRED