

P/N 46112-601 SHOWN

POWER HOUSING ASSY W/ INTERLOCK

NO OF CKT	MATERIAL NUMBER	COMPLIANT PIN PLATING	DIM A	DIM B SEE SHT 2	DIM C SEE SHT 2
2	46112-0201	TIN	12.24/1.482	12.75/1.502	2.69/1.106
4	46112-0401	TIN	24.24/1.954	24.74/1.974	
6	46112-0601	TIN	36.24/1.427	36.75/1.447	
8	46112-0801	TIN	48.24/1.899	48.74/1.919	
10	46112-1001	TIN	60.24/2.372	60.76/2.392	
12	46112-1201	TIN	75.00/2.953	75.51/2.973	
14	46112-1401	TIN	84.24/3.317	84.76/3.337	

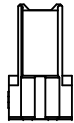
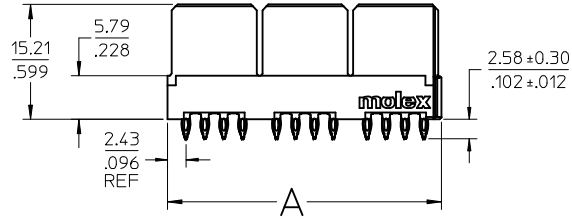
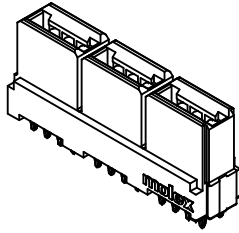
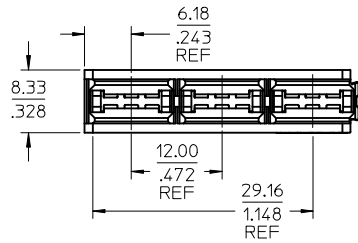

NOTES:

1. MATERIAL: HOUSING: LCP, 94-V0, COLOR: BLACK.  
POWER CONTACTS: COPPER ALLOY.  
SIGNAL CONTACTS: MODIFIED TIN BRASS.
2. FINISH: SELECT GOLD - 0.75 μM/30 μ INCHES  
SELECTED TIN - 1.91 μM/75 μ INCHES
3. POWER CONTACTS ARE LUBRICATED IN CONTACT AREA.
4. PARTS ARE RoHS COMPLIANT.
5. MATES TO MOLEX P/N 45985-SERIES OR EDGE CARD 157/1.062.
6. PRODUCT SPECIFICATION PS-46114-001.
7. PACKAGING: PER PK-46114-003.

POWER HOUSING ASSY WITH (2) GUIDES

NO OF CKT	MATERIAL NUMBER	COMPLIANT PIN PLATING	DIM A	DIM B	DIM C
2	46112-0203	TIN	18.94/1.746	19.46/1.766	5.45/1.215
4	46112-0403	TIN	30.94/1.218	31.45/1.238	
6	46112-0603	TIN	42.94/1.691	43.46/1.711	
8	46112-0803	TIN	54.94/2.163	55.45/2.183	
10	46112-1003	TIN	66.94/2.635	67.44/2.655	
12	46112-1203	TIN	78.94/3.108	79.45/3.128	
14	46112-1403	TIN	90.94/3.580	91.44/3.600	

P/N 46112-603 SHOWN

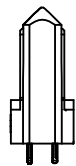
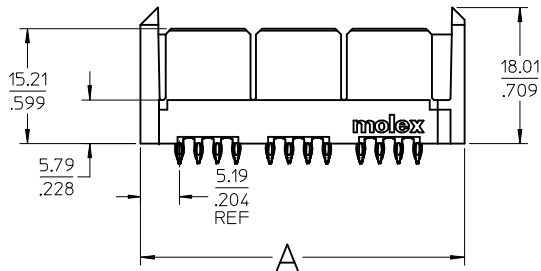
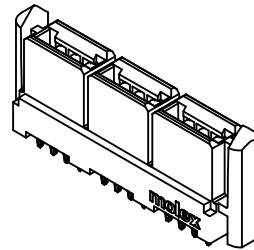
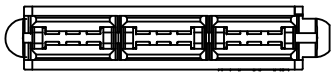

REMOVE TINLEAD EC NO: UCP2016-2607 DRWNGES 2015/12/24 CHKD: APPR: BPLSZLZOR 2016/01/20 REV: C5	QUALITY SYMBOLS	GENERAL TOLERANCES (UNLESS SPECIFIED)	DIMENSION STYLE IN/MM	SCALE 2:1	DESIGN UNITS INCH	THIRD ANGLE PROJECTION
	▽=0	4 PLACES ± --- ± ---	mm INCH	DRAWN BY DATE	TITLE	LPH VERTICAL RECEPTACLE POWER ASSEMBLY 2 CKT-14 CKT, PRESS-FIT <b>molex</b>
	▽=0	3 PLACES ± --- ± .010		CHECKED BY DATE		
	▽=0	2 PLACES ± 0.25 ± ---	ANGULAR ±1/2°	APPROVED BY DATE	JCOMERC I 2009/12/03	DOCUMENT NO.
	▽=0	1 PLACE ± --- ± ---	DRAFT WHERE APPLICABLE MUST REMAIN WITHIN DIMENSIONS	MATERIAL NO.	SEE CHART	SD-46112-200
			SIZE C	THIS DRAWING CONTAINS INFORMATION THAT IS PROPRIETARY TO MOLEX INCORPORATED AND SHOULD NOT BE USED WITHOUT WRITTEN PERMISSION		SHEET NO. 1 OF 2

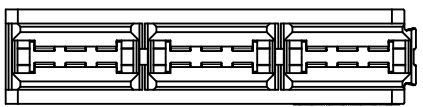
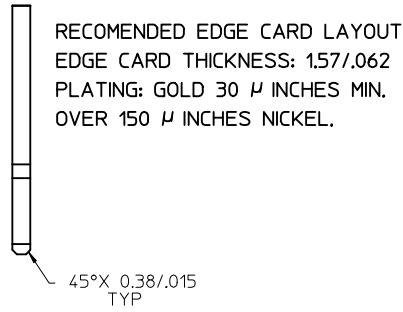
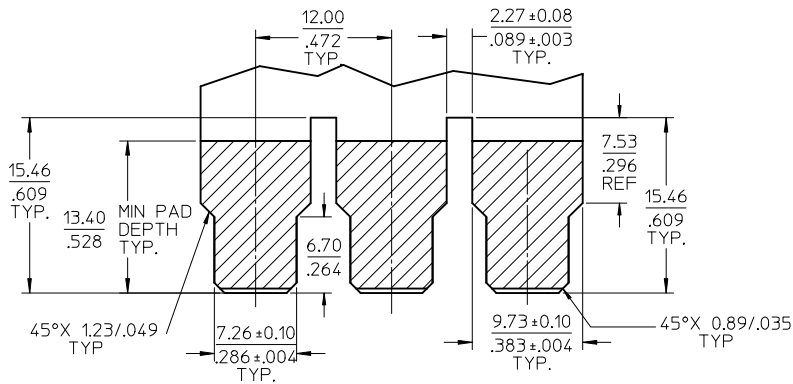

P/N 46112-601 SHOWN

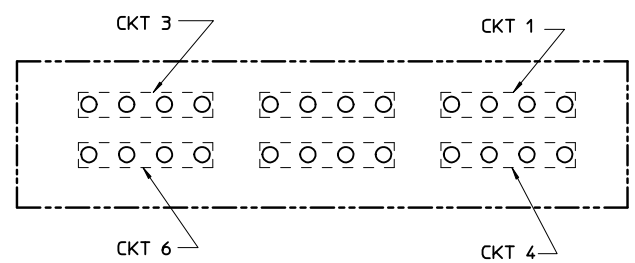

PCB LAYOUT: COMPONENT SIDE  
SCALE 4:1

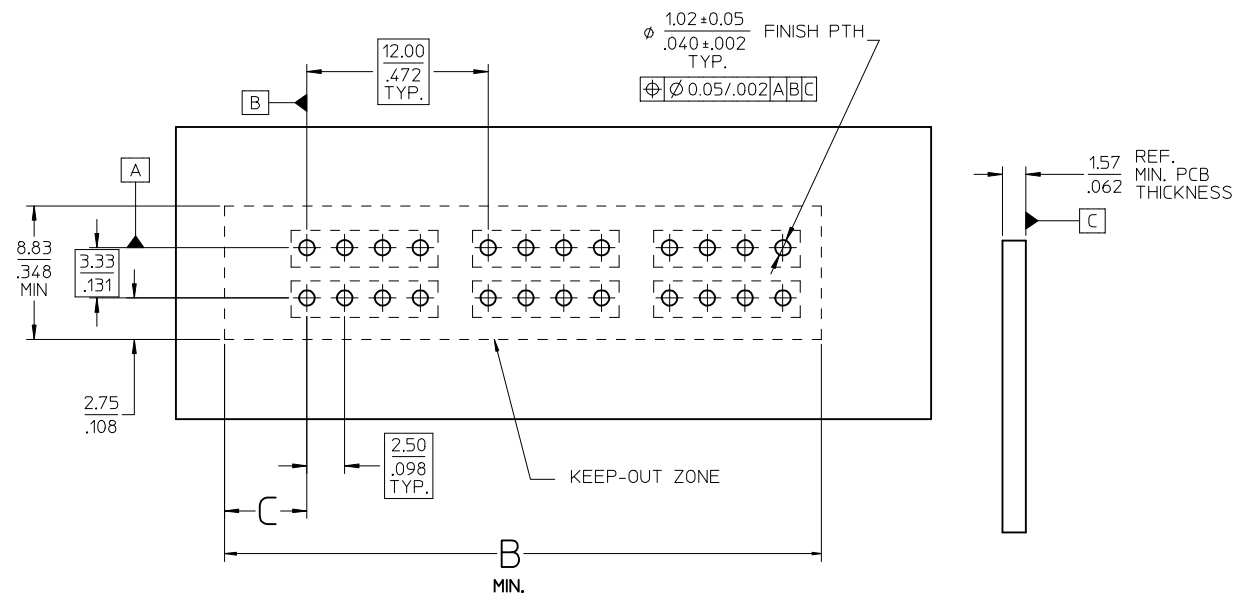

PCB COMPONENT SIDE  
SCALE 4:1

SEE SHEET 1 IEC NO: UCP2016-2607 DRAWINGS 2015/12/24 CHKD: JCOMERC I APPR: BPI/SZCZOR 2016/01/20	QUALITY SYMBOLS	GENERAL TOLERANCES (UNLESS SPECIFIED)	DIMENSION STYLE	SCALE	DESIGN UNITS	THIRD ANGLE PROJECTION
	▽=0	mm INCH	IN/MM	3:1	INCH	
	▽=0	4 PLACES ± --- ± ---	DRAWN BY DATE	TITLE	LPH VERTICAL RECEPTACLE POWER ASSEMBLY	
	▽=0	3 PLACES ± --- ± .010	CHECKED BY DATE	2 CKT-14 CKT, PRESS-FIT		
	▽=0	2 PLACES ± 0.25 ± ---	APPROVED BY DATE	molex		
		1 PLACE ± --- ± ---	JCOMERC I 2009/12/03	DOCUMENT NO. SD-46112-200		
		0 PLACE ± --- ± ---	MATERIAL NO. SEE CHART	SHEET NO. 2 OF 2		
		ANGULAR ±1/2°	SIZE C	THIS DRAWING CONTAINS INFORMATION THAT IS PROPRIETARY TO MOLEX INCORPORATED AND SHOULD NOT BE USED WITHOUT WRITTEN PERMISSION		
		DRAFT WHERE APPLICABLE MUST REMAIN WITHIN DIMENSIONS				