

Data Sheet

RP023xxHBWC

Page 1/5

P/N

311661xx

xx=number of poles

2017/01/24

Illustration

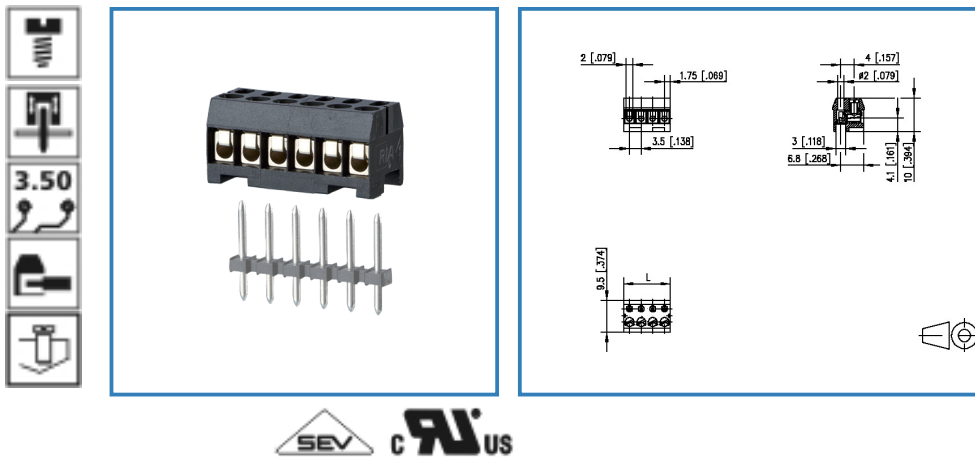

see enlarged drawing at the end of the document

Product specification

- screw type terminal block, pluggable
- centerline 3.50 mm, direction of connection 90°
- wire protector, fittable without loss of poles
- color black
- Wire entry perpendicular to plug direction



Data Sheet

RP023xxHBWC

Technical Data

General Data

Tightening torque SEV	0.15 Nm		
Tightening torque UL	3 lb-in		
min. number of poles	2		
max. number of poles	24		
Insulating material class	CTI 600		
clearance/creepage dist.	2 mm		
protection category	IP 00		
Overvoltage category	III	III	II
Pollution degree	3	2	2
Rated voltage	160 V	400 V	400 V
Rated test voltage	2.5 kV	2.5 kV	2.5 kV

Connection data

Rated wiring solid wire	0.08 - 0.75 mm ² / AWG 28 - 18		
Rated wiring stranded wire	0.08 - 0.75 mm ² / AWG 28 - 18		

Approvals

 US V / A / AWG	125 / 8 / 28 - 16		
---	-------------------	--	--

	6 A / 200 V / 2.5 kV / 3 / IEC 61984 / 0.08 - 1 mm ²		
--	--	--	--

Material

insulating material	PA66		
flammability class	V0		
contact material	CuNiZn		
Glow-Wire Flammability GWFI	960		
Glow-Wire Flammability GWIT	775		
terminal body material	CuZn		
terminal body surface	Ni		
screw surface	Zn Cr(VI)-frei/free		
wire protector material	CuNiZn		
screw thread	M2		

Climatic properties

upper limit temperature	105 °C		
lower limit temperature	-40 °C		

Data Sheet

RP023xxHBWC

Page 3/5

P/N

311661xx

xx=number of poles

2017/01/24

General

Tolerance	ISO 2768 -mH
-----------	--------------



METZ CONNECT GmbH

Im Tal 2 | 78176 Blumberg | Germany | www.metz-connect.com

Phone +49 7702 533-0 | Fax +49 7702 533-433

Montageanleitung / Mounting instruction siehe / see www.metz-connect.com

Members of METZ CONNECT



Data Sheet

RP023xxHBWC

Page 4/5

P/N

311661xx

xx=number of poles

2017/01/24

Matching Part

P/N	Product name
312241	PR033xxVBHC Typ 224
312251 (on request)	PT153xxHBEC Typ 225
312261 (on request)	PT153xxVBEC Typ 226
313331 (on request)	PT023xxHBHC
314241	PM013xxVBHC Typ 424

Accessories

P/N	Product name
720158-01-0 (on request)	F_Befest_165_brg_kurz 1mm
720158-01-2 (on request)	720158
720158-02-2	720158
720159-01-0 (on request)	F_Kodier_Typ165_brg_kurz
720159-01-2	720159
720159-02-0 (on request)	F_Kodier_Typ165_brg_lang
720159-02-2	720159



Data Sheet

RP023xxHBWC

Page 5/5

P/N

311661xx

xx=number of poles

2017/01/24

Illustration

Drawing

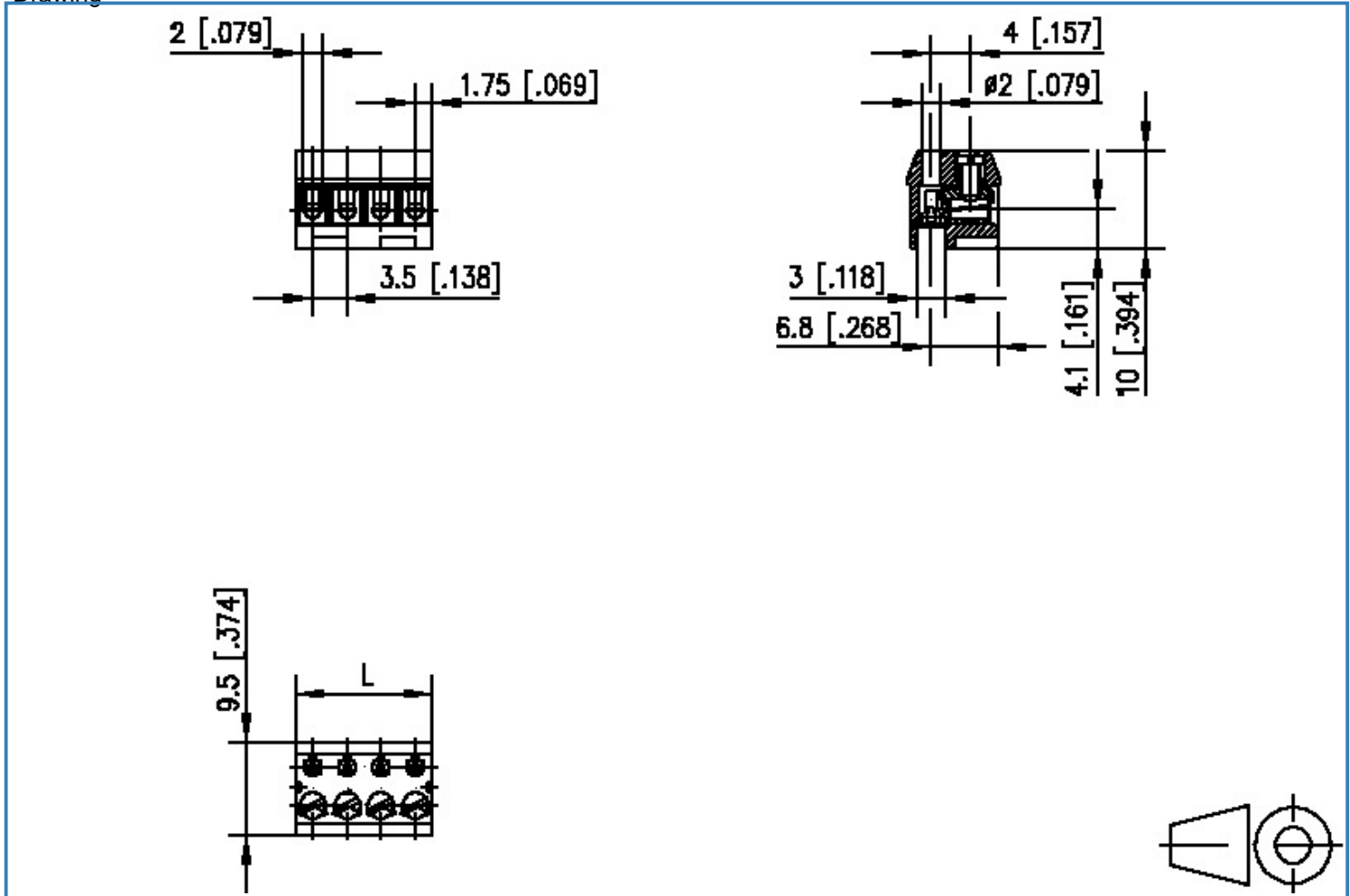

$L = (\text{pole size} - 1) \times \text{centerline} + 3.5 [0.138]$

