

DO NOT SCALE

DIMENSIONS IN mm

METRIC

THIRD ANGLE  
PROJECTION

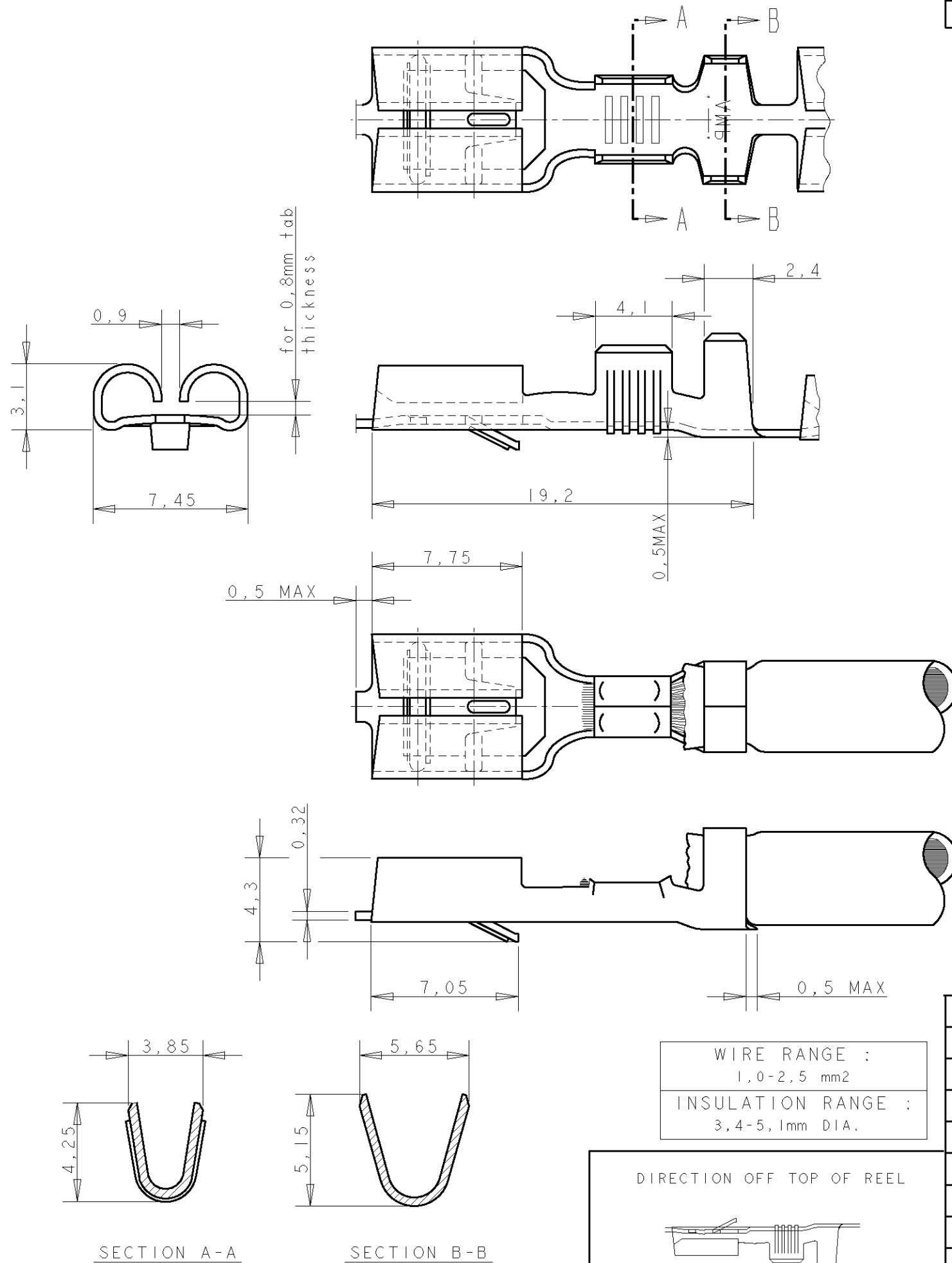
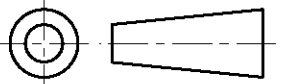

NOTES

- 1 FOR USE ON MINIATURE APPLICATORS ( LEFT-RIGHT FEED ) AND STANDARD APPLICATORS ( RIGHT-LEFT FEED ).
- 2 FOR USE ON MINIATURE APPLICATORS ( AMP-O-MATOR APPLICATION). ( LEFT-RIGHT FEED ).
- 3 OBSOLETE PARTS: OBSOLETE CIS STREAMLINING PER D.RENAUD/D.SINISI

GENERAL TOLERANCES  $\pm 0.3$

| NOTES | FINISH        | MATERIAL  | PARTNUMBER |
|-------|---------------|-----------|------------|
| 1     | PRE-TINPLATED | PH.BRONZE | 6-160448-8 |
| 2     | PRE-TINPLATED | BRASS     | 6-160448-7 |
| 1/2   | SILVERPLATED  | BRASS     | 6-160448-6 |
| 1     | TINPLATED     | BRASS     | 6-160448-5 |
| 1     | SILVERPLATED  | PH.BRONZE | 6-160448-3 |
| 1     | TINPLATED     | PH.BRONZE | 6-160448-2 |
| 1     | UNPLATED      | PH.BRONZE | 6-160448-1 |
| 1     | UNPLATED      | BRASS     | 6-160448-0 |

OBSOLETE  
3

CUSTOMER DRAWING FOR REFERENCE ONLY  
WILL NOT BE UPDATED

THIS DRAWING IS UNPUBLISHED  
RELEASED FOR PUBLICATION



NAME  
.250 SRS FASTIN-ON RECEPTACLE.

|       |                           |       |           |         |
|-------|---------------------------|-------|-----------|---------|
| K2    | REVISED PER ECO-11-005140 | RK    | HMR       | 19APR11 |
| LTR.  | REVISION RECORD           | DR.   | CHK.      | DATE    |
| DR.:  | J.v.LIEMPT.               | CHK.: | A.BIJNEN. | APP.:   |
| DATE: | 23 MAR 1992               | DATE: | -         | DATE:   |

|         |          |          |    |       |        |    |
|---------|----------|----------|----|-------|--------|----|
| DWG.No. | C-160448 | REV.LTR. | K2 | SHEET | 1 OF 1 | A3 |
|---------|----------|----------|----|-------|--------|----|