

REV.	DATE	DESCRIPTION
A	05/17/04	UPDATE BODY / UPDATE DRAWING FORMAT

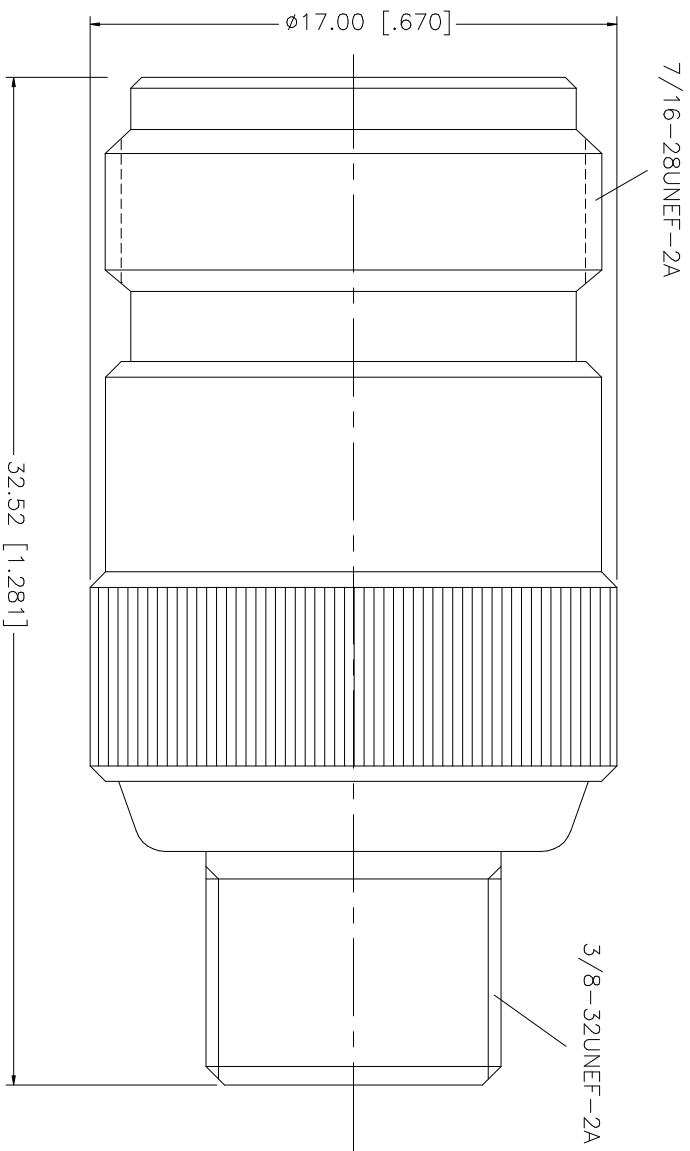

8																						
7																						
6																						
5																						
4																						
3	CONTACT PIN	PHOS. BRONZE	GOLD	1																		
2	INSULATOR	TEFLON	NATURAL	1																		
1	BODY	BRASS	NICKEL	1																		
	DESCRIPTION	MATERIAL	FINISH	QTY																		

UNLESS OTHERWISE SPECIFIED DIMENSIONS ARE IN MILLIMETERS. DIMENSIONS IN [] ARE IN INCHES AND FOR CUSTOMER REFERENCE ONLY.	
TOLERANCES FOR MILLIMETERS ARE:	
0.5 - 8mm	± 0.20mm
8 - 30mm	± 0.40mm
30 - 120mm	± 0.50mm
UNLESS OTHERWISE SPECIFIED DIMENSIONS ARE IN INCHES AND FOR CUSTOMER REFERENCE ONLY.	
TOLERANCES FOR INCHES ARE:	
.020 - .315	± 0.007"
.315 - 1.180	± 0.015"
1.180 - 4.724	± 0.020"
DO NOT SCALE DRAWING	

APPROVALS	DATE
DRAWN G.R.S.	05/17/04
CHECKED	
ISSUED	
SHEET 1 OF 1	

CAD FILE	C:/242/242120.DWG	DWG. NO.	242120.DWG	REV.	A	SIZE	A	SCALE	NA
----------	-------------------	----------	------------	------	---	------	---	-------	----

Amphenol Connex

PART DESCRIPTION
N FEMALE TO F FEMALE ADAPTER

PART NO. 242120