

PC board drilling dimensions(after plating)
(thickness ≤ 3.20±0.30mm)

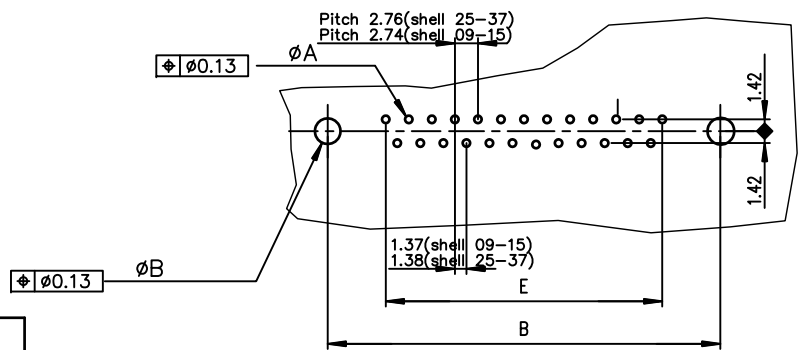

ROHS PART NUMBER

SHELL	A±0.38	B±0.12	C±0.10	D±0.25	E±0.07	200 Mating	500 Mating
09	30.81	24.99	16.96	16.79	10.96	D09P90C4GX00LF	D09P90C6GX00LF
15	39.14	33.32	25.18	25.12	19.18	D15P90C4GX00LF	D15P90C6GX00LF
25	53.03	47.04	39.12	38.84	33.12	D25P90C4GX00LF	D25P90C6GX00LF
37	69.32	63.50	55.68	55.30	49.68	D37P90C4GX00LF	D37P90C6GX00LF

GENERAL CHARACTERISTICS AND ROHS INFORMATIONS:
SEE DRAWING C01-8646-0001

mat'l. code		surface ISO 1302		tolerance ISO 406 ISO 1101		projection		product family D-SUB	
ltr	ecn no	dr	date	tolerances unless otherwise specified		mm		title	
E	ELX-I-21654	AB	2015-10-26	angles	linear	.0±0.1 .00±0.1 .000±0.1		MALE DELTA-D LOW PROFILE STRAIGHT PRESS-FIT	
F	ELX-I-24020	AAB	2016-06-06	0°±2'		scale 2:1		dwg no sheet 1 of 1 size	
				dr		PESSON		1997-01-21	
				engr		MITHUN PAUL		2016-06-06	
				chr		ATHUL A.B		2016-06-06	
				appd		BIJU K PAUL		2016-06-06	
sheet index		revision sheet		F 1				Amphenol FCI	
								C01-8646-0532 A3	
								type Product Customer Drawing	