

MATERIAL NO.	ENG. NO.	STUD SIZE	$\phi S \pm .005$
190710218	E-660-08X	08	.173
190710221	E-660-10X	10	.198
190710225	E-660-14X	1/4	.265
190710229	E-660-56X	5/16	.328

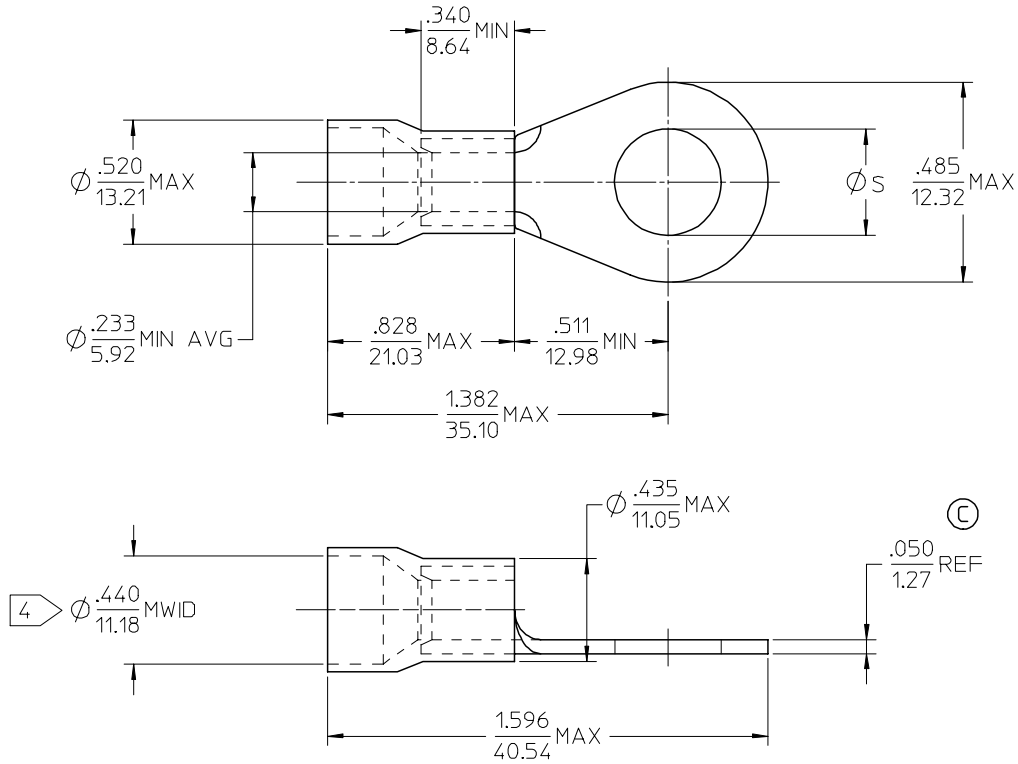

NOTE(S):

1. TERMINAL MATERIAL: COPPER ALLOY.
2. TERMINAL FINISH: ELECTRO TIN PLATE.
3. INSULATION MATERIAL: PVC, COLOR CODED BLUE.

MWID = MAXIMUM WIRE INSULATION DIAMETER.

5. ALL COMPONENTS ARE ROHS COMPLIANT.

REV	DESCRIPTION	QUALITY SYMBOLS	GENERAL TOLERANCES (UNLESS SPECIFIED)		DIMENSION STYLE		SCALE	DESIGN UNITS	THIRD ANGLE PROJECTION
			mm	INCH	IN/MM	INCH			
		=0	4 PLACES	±----	±----	DRAWN BY	DATE	TITLE <b>RING TONGUE TERMINAL INSULKRIMP, 660 SERIES 6 AWG</b>	
		=0	3 PLACES	±----	±----	EHILE	2006/10/10		
			2 PLACES	±----	±----	CHECKED BY	DATE		
			1 PLACE	±----	±----	JMACNEIL	2006/10/10		
			ANGULAR ±---°			APPROVED BY	DATE	MATERIAL NO. <b>SEE CHART</b>	
			DRAFT WHERE APPLICABLE MUST REMAIN WITHIN DIMENSIONS			JMACNEIL	2006/10/10		
						SIZE		DOCUMENT NO. <b>SD-19071-015</b>	
						B		SHEET NO. <b>1 OF 1</b>	