

## Feed-through header - PC 6-16/ 3-G1F-10,16 - 1999013

Please be informed that the data shown in this PDF Document is generated from our Online Catalog. Please find the complete data in the user's documentation. Our General Terms of Use for Downloads are valid (<http://phoenixcontact.com/download>)

PCB headers, nominal current: 76 A, rated voltage (III/2): 1000 V, number of positions: 3, pitch: 10.16 mm, color: green, contact surface: Silver, mounting: Wave soldering



The figure shows a 5-pos. version of the product

### Why buy this product

- Well-known mounting principle allows worldwide use
- Screwable flange for superior mechanical stability
- Maximum flexibility when it comes to device design – one header for connectors with different connection technologies

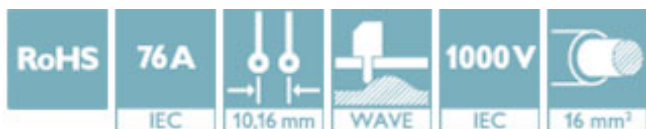

### Key Commercial Data

Packing unit	50 STK
GTIN	
GTIN	4046356038515

### Technical data

#### Dimensions

Length [ l ]	34 mm
Width	48.24 mm
Pitch	10.16 mm
Dimension a	20.32 mm
Width [ w ]	48.24 mm
Height [ h ]	17.4 mm
Constructional height	13.4 mm
Length of the solder pin	4 mm
Pin dimensions	1 x 1.2 mm
Pin spacing	1.16 mm
Length	34 mm

#### General

# Feed-through header - PC 6-16/ 3-G1F-10,16 - 1999013

## Technical data

### General

Range of articles	PC 6-16/..-G1F
Insulating material group	I
Rated surge voltage (III/3)	8 kV
Rated surge voltage (III/2)	8 kV
Rated surge voltage (II/2)	6 kV
Rated voltage (III/3)	1000 V
Rated voltage (III/2)	1000 V
Rated voltage (II/2)	1000 V
Connection in acc. with standard	EN-VDE
Nominal current $I_N$	76 A (41 A in combination with PC 6 plug)
Maximum load current	76 A (41 A in combination with PC 6 plug)
Insulating material	PA
Flammability rating according to UL 94	V0
Color	green
Number of positions	3

### Standards and Regulations

Connection in acc. with standard	EN-VDE
	CUL
Flammability rating according to UL 94	V0

### Environmental Product Compliance

China RoHS	Environmentally friendly use period: unlimited = EFUP-e
	No hazardous substances above threshold values

## Drawings

Diagram

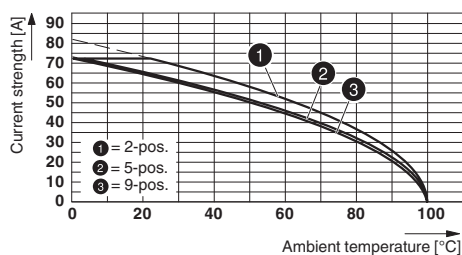

Drilling diagram

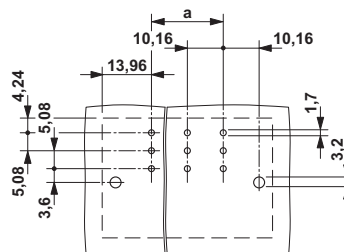

Type: PC 16/...-STF-10,16 with PC 6-16/...-G1F-10,16

# Feed-through header - PC 6-16/ 3-G1F-10,16 - 1999013

Dimensional drawing

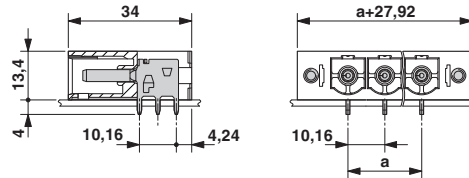

## Approvals

### Approvals

Approvals

SEV / IECCEB Scheme / EAC / cULus Recognized

Ex Approvals

### Approval details

SEV		<a href="https://www.electrosuisse.ch/en/meta/shop/product-certificates.html">https://www.electrosuisse.ch/en/meta/shop/product-certificates.html</a>	IK-3431
Nominal voltage UN		1000 V	
Nominal current IN		76 A	

IECEE CB Scheme		<a href="http://www.iecee.org/">http://www.iecee.org/</a>	CH-8077
Nominal voltage UN		1000 V	
Nominal current IN		76 A	

EAC		B.01742	
-----	--	---------	--

## Feed-through header - PC 6-16/ 3-G1F-10,16 - 1999013

### Approvals

cULus Recognized		<a href="http://database.ul.com/cgi-bin/XYV/template/LISEXT/1FRAME/index.htm">http://database.ul.com/cgi-bin/XYV/template/LISEXT/1FRAME/index.htm</a> E60425-20040202	
	D	B	C
Nominal voltage UN	600 V	300 V	300 V
Nominal current IN	5 A	66 A	66 A

Phoenix Contact 2018 © - all rights reserved  
<http://www.phoenixcontact.com>

PHOENIX CONTACT GmbH & Co. KG  
Flachsmarktstr. 8  
32825 Blomberg  
Germany  
Tel. +49 5235 300  
Fax +49 5235 3 41200  
<http://www.phoenixcontact.com>