

Tous droits strictement réservés. Reproduction ou communication o des liers interdite sous quelque forme que ce soit sans autorisation écrite du propriétaire. Propriété de c FCI. Droits de reproduction FCI.

All rights strictly reserved. Reproduction or issue to third parties in any form without written permission from the proprietor. Property of FCI. Copyright FCI.

PRODUCT NO. 51730-122-- NOTE ③	ROWS D C B A	PWR		SIG				PWR	
		E1	P1	1	2	3	4	P2	E2

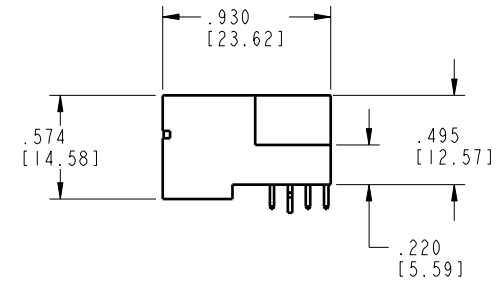
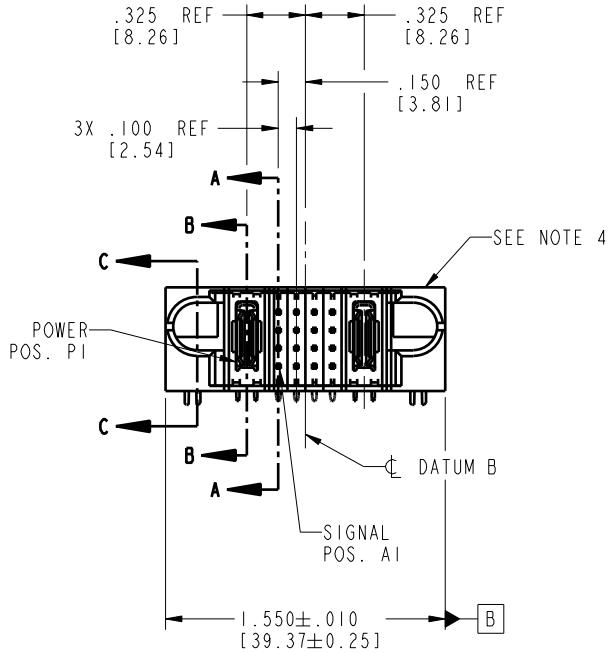

CODE	DIM "M" MATING LENGTH	CONTACT TYPE
U	.270 [6.86]	SIGNAL
T	.270 [6.86]	SIGNAL
S	.270 [6.86]	SIGNAL
R	.270 [6.86]	SIGNAL
F	.220 [5.59]	SIGNAL
PA	N/A [N/A]	POWER
HA	N/A [N/A]	HOLD-DOWN

mat'l code				SEE NOTE 2		tolerances unless otherwise specified		CUSTOMER	
lir	ecr no.	dr	date	linear	.XX±.01/0.X±0.3	COPY		A FCI www.fciconnect.com	
A	DG06-0067	RYAN	02/23/06	angles	.XXX±.005/0.XX±0.13	projection	title		
				dr	.XXX±.002/0.XXX±0.051	INCH/MM		IP + 16S + IP R/A SOLDER HEADER	
				engr	0°±2°	scale	product family	PwrBlade	code
				chr	RYAN YUAN 02/23/06	1:1	size		213
				opod	SALLY LUO 02/23/06		dwg no		sheet
					BEER FU 02/23/06		51730-122	1 of 4	
					JOSEPH HSIA 02/23/06				
sheet index	revision	A	A	A	A				
	sheet	1	2	3	4				

code code 22526

Pro/E

Tous droits strictement réservés. Reproduction ou communication à des tiers interdite sous quelque forme que ce soit sans autorisation écrite du propriétaire. Propriété de c FCI. Droits de reproduction FCI.

All rights strictly reserved. Reproduction or issue to third parties in any form whatsoever is not permitted without written authority from the proprietor. Property of FCI. Copyright FCI.

PRODUCT NUMBER
51730-122--
NOTE ③

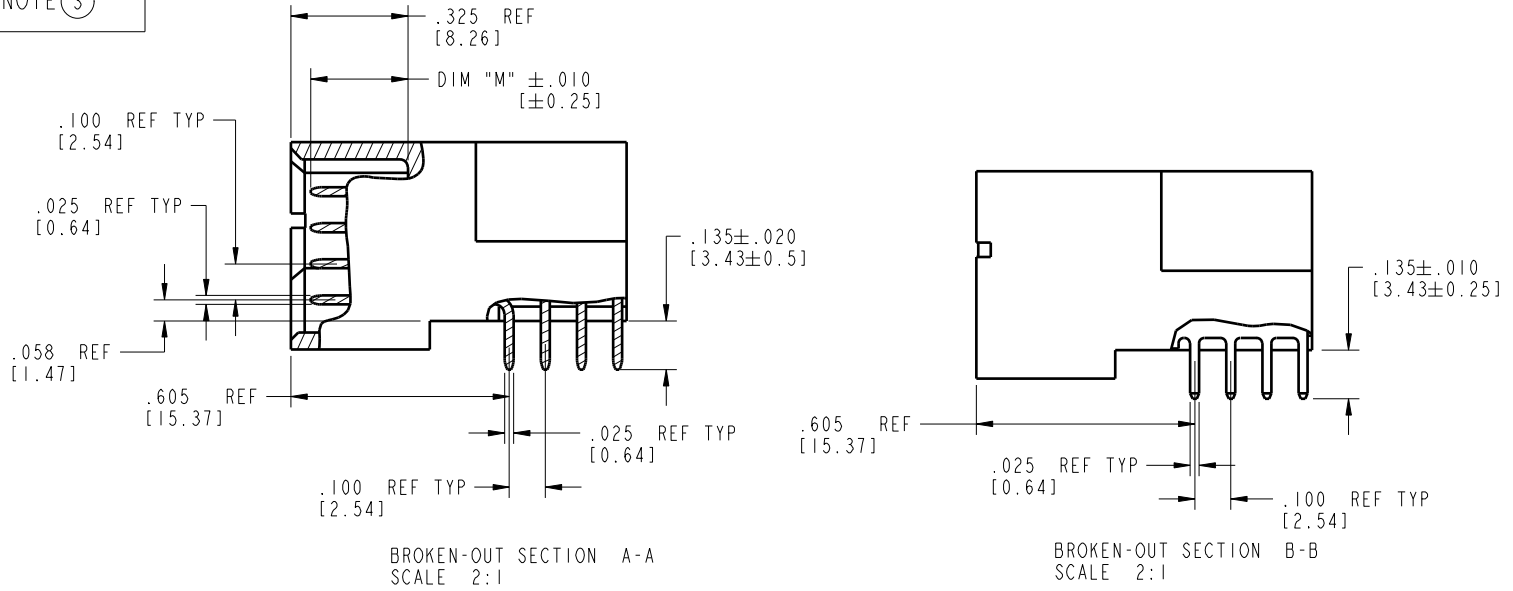

mat'l code		SEE NOTE 2		tolerances unless otherwise specified		CUSTOMER		A FCI		www.fciconnect.com	
lir	ecm no.	dr	date	linear	.XX±.01/0.X±0.3	COPY		projection	title		
A					.XXX±.005/0.XX±0.13				IP + 16S + 1P		
				angles	.XXX±.002/0.XXX±0.051				R/A SOLDER HEADER		
				dr	0°±2°	RYAN YUAN 02/23/06			product family	PwrBlade	code
				eng		SALLY LUO 02/23/06			size	A	213
				chr		BEER FU 02/23/06			scale	1:1	sheet
				appd		JOSEPH HSIA 02/23/06					2 of 4
sheet index	revision sheet										

code code 22526

Pro/E

Tous droits strictement réservés. Reproduction ou communication à des tiers interdite sans quelque forme que ce soit sans autorisation écrite du propriétaire. Propriété de c FCI. Droits de reproduction FCI.

All rights strictly reserved. Reproduction or issue to third parties in any form whatsoever is not permitted without written authority from the proprietor. Property of FCI. Copyright FCI.

PRODUCT NUMBER
51730-122--
NOTE ③

1 | 2

3 |

4

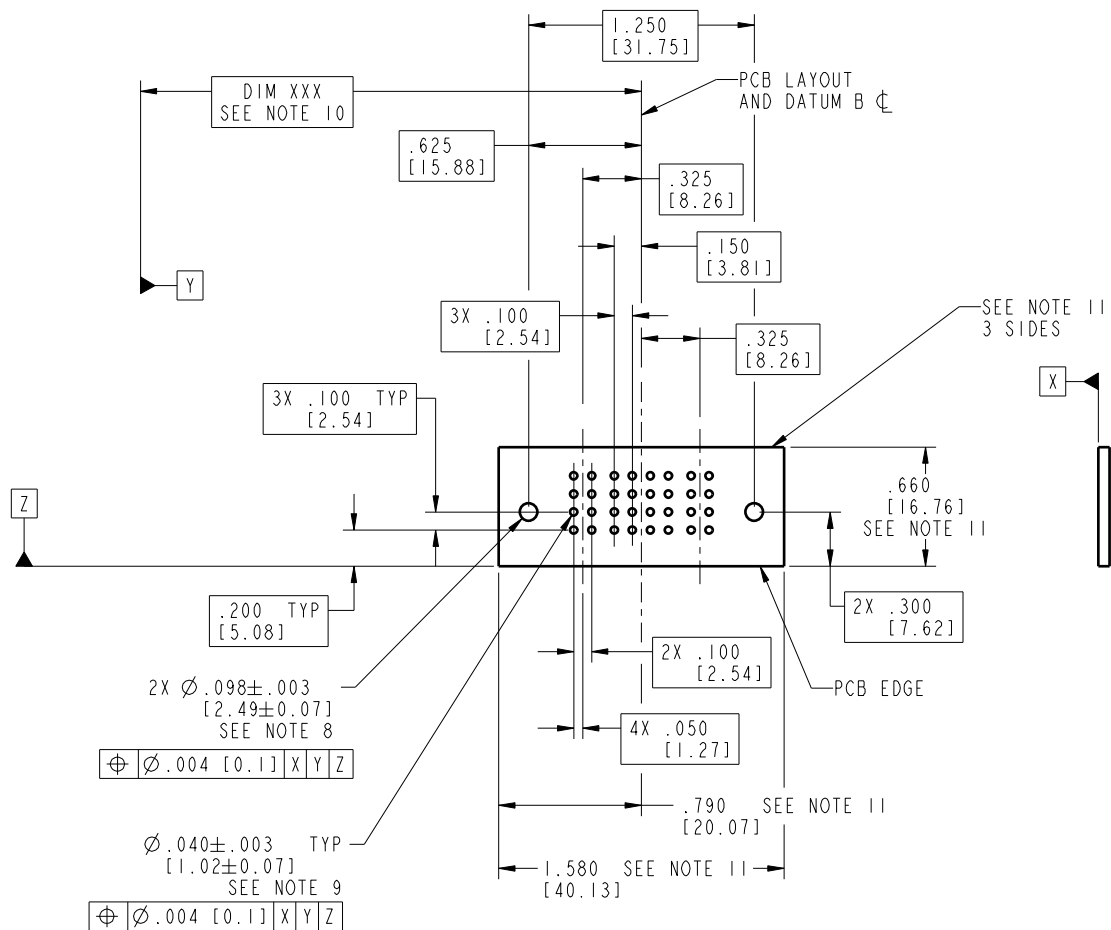

RECOMMENDED PCB LAYOUT

mat'l code				SEE NOTE 2	tolerances unless otherwise specified		CUSTOMER		 www.fciconnect.com
lir	ecr no.	dr	date	linear	.XX±.01/0.X±0.3	COPY		projection	
A				angles	.XXX±.005/0.XX±0.13	INCH/MM		title	
				dr	.XXX±.002/0.XXX±0.051	scale		IP + 16S + IP	
				engr	0° ± 2°	1:1		R/A SOLDER HEADER	
				chr	RYAN YUAN 02/23/06	product family		PwrBlade	
				opd	SALLY LUO 02/23/06	size		code	
					BEER FU 02/23/06	A		213	
					JOSEPH HSIA 02/23/06	51730-122		sheet	
sheet index	revision	sheet						3 of 4	

code code 22526

Pro/E

1 | 2

3 |

4

Tous droits strictement réservés. Reproduction ou communication à des tiers interdite sans quelque forme que ce soit sans autorisation écrite du propriétaire. Propriété de c FCI. Droits de reproduction FCI.



All rights strictly reserved. Reproduction or issue to third parties in any form whatsoever is not permitted without written authority from the proprietor. Property of FCI. Copyright FCI.

1 | 2

3 |

4

PRODUCT NUMBER

51730-122--
NOTE ③

NOTES:

1. DIMENSIONS AND TOLERANCES ARE IN ACCORDANCE WITH ASME Y14.5M, 1994 UNLESS OTHERWISE SPECIFIED.

CONNECTOR NOTES:

- ② HOUSING MATERIAL: UL 94 V-0 GLASS FILLED HIGH-TEMP THERMOPLASTIC
POWER CONTACT MATERIAL: COPPER ALLOY
SIGNAL PIN MATERIAL: COPPER ALLOY
- ③ PLATING:
SEE PRINT 10064183 FOR PLATING SPEC OF 51730-122; 51730-122LF
- ④ MANUFACTURER'S NAME, P/N, AND DATE CODE TO APPEAR ON THIS SURFACE.
- 5. PRODUCT SPECIFICATION GS-12-149.
APPLICATION SPECIFICATION BUS-20-067.
- 6. PACKAGED IN TRAYS.

PCB NOTES:

- 7. ALL HOLE DIAMETERS ARE FINISHED HOLE SIZE.
- ⑧ MOUNTING HOLES, WHERE APPLICABLE, ARE UNPLATED.
- ⑨ $\varnothing .0453 \pm .0010$ [1.151 \pm 0.025] DRILLED HOLES PLATED WITH
.0003 [0.008] MIN SnPb OVER .001 [0.03]
TO .003 [0.08] Cu PLATING TO ACHIEVE
 $\varnothing .040 \pm .003$ [1.02 \pm .07] HOLE.
- ⑩ "DIM XXX" TO BE DETERMINED BY THE CUSTOMER.
- ⑪ CONNECTOR KEEP-OUT ZONE.

A

A

B

B

mat'l code				SEE NOTE 2	tolerances unless otherwise specified		CUSTOMER		A FCI		www.fciconnect.com	
lir	ecn no.	dr	date	linear	.XX±.01/0.X±0.3	COPY		projection		title		
A					.XXX±.005/0.XX±0.13					IP + 16S + 1P R/A SOLDER HEADER		
				angles	.XXX±.002/0.XXX±0.051					product family		
				dr	0° ± 2°	INCH/MM		PwrBlade		code		
				eng	RYAN YUAN 02/23/06	size		A		213		
				chr	SALLY LUO 02/23/06	scale		51730-122		sheet		
				opod	BEER FU 02/23/06	1:1				4 of 4		
					JOSEPH HSIA 02/23/06							
sheet index	revision sheet											

1 | 2

Pro/E

3 |

code code 22526

4